

LINKBOX PoP

Point to Point Fiber Link Modules

PoP B3 / B4

SDI Fiber Pair Transceiver

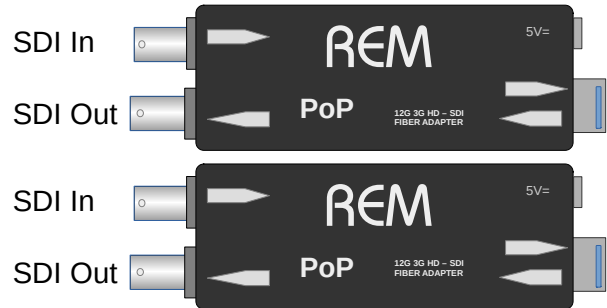
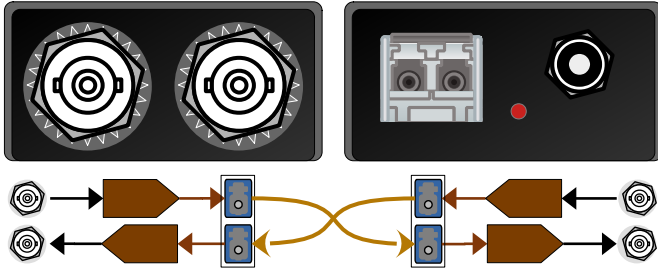

PoP S3 / S4

SDI Single Fiber Transceiver

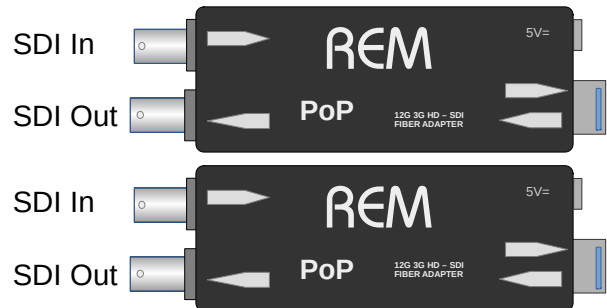
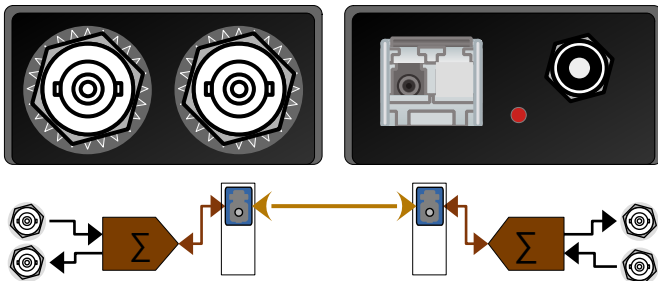

PoP MH / M4

SDI Single Fiber Transmitter

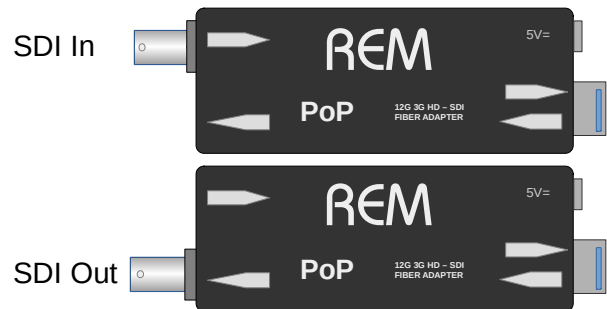
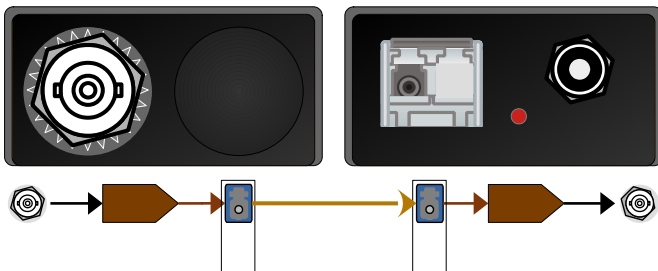

PoP Specifications & Notes

PoP Series Notes:

Furniture includes 2x Modules, SFP Modules, 2x AC power supply
 All products are available in 3G [x3] or 12G SDI [x4,xH] format
 All products use singlemode fiber and LC/UPC connectors
 All products with two fiber require a standard crossed fiber pair
 1RU option frame can carry up to 7 modules

PoP Series Specifications:

SDI In/Out: 75 Ohm BNC [SMPTE 259M, 292M, 424M]+[(12x) ST-2081, ST-2082]
Power: +5V DC – 2.5W Max (with LED indicator)
Size: 125 x 50 x 32 mm. 135g (4.8 oz) Connector included
Ambient: 5 - 40°C (41 - 104°F) 90% Humidity (non condensing)
Max fiber length: All 3G: 9Km. 12B-O & 12T: 9Km. 12S: 3Km

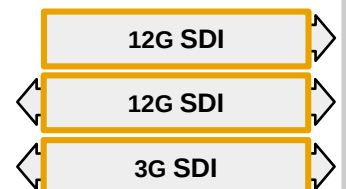

LINKBOX PoP-VE

Point to Point Fiber Link Modules

PoP – VE B3 / B4

SDI+LAN Fiber Pair Transceiver

Bidirectional SDI (3G or 12G)
with Ethernet 10/100/1000
with V-Lock Plate Option

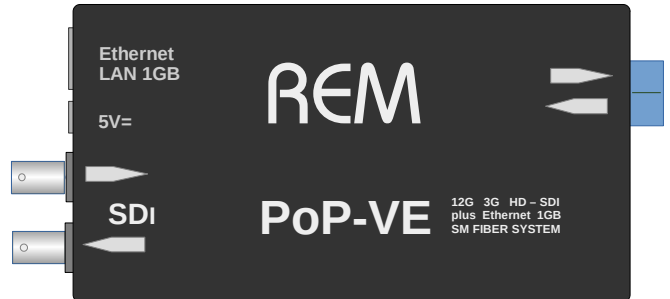
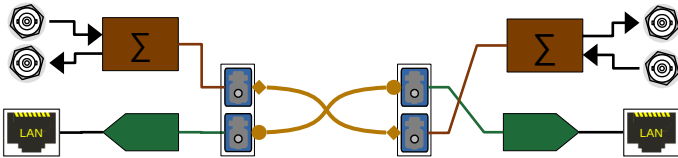

PoP-VE M3 / M4

SDI+LAN Fiber Pair Transmitter

Unidirectional SDI (3G or 12G)
with Ethernet 10/100/1000
with V-Lock Plate Option

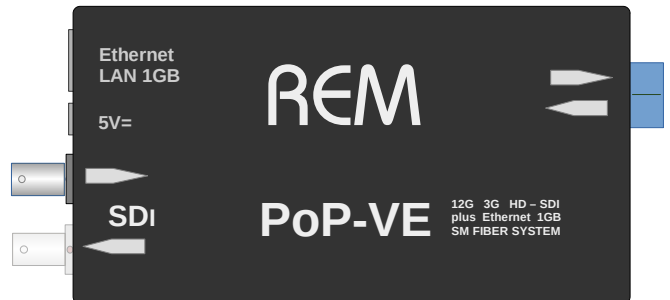

PoP – VE

Application Examples

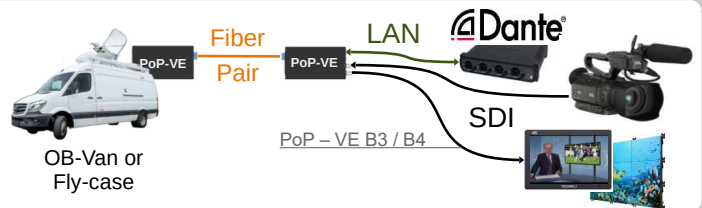
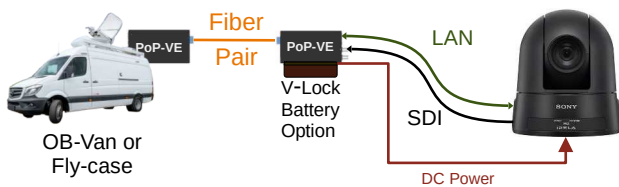

PoP Specifications & Notes

PoP Series Notes:

Furniture includes 2x Modules, 2x AC power supply
All products are available in 3G [B3] or 12G SDI [B4mM4] format
All products use singlemode fiber and LC/UPC connectors
All products require a standard crossed fiber pair
1RU option frame can carry up to 4 modules

PoP Series Specifications:

SDI In/Out: 75 Ohm BNC [SMPTE 259M, 292M, 424M]+[(12x) ST-2082]
Power: +5V DC – 2.5W Max (with LED indicator)
Size: 165 x 80 x 32 mm. 135 g (13.4 oz) Connector & Power Brick excluded
Ambient: 5 - 40°C (41 - 104°F) 90% Humidity (non condensing)
Max fiber length: All 3G: 9Km. 12B-O & 12T: 9Km. 12S: 3Km

Crossed

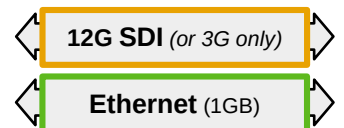

Cambox PoP

Point to Point Fiber Link Modules

Battery Option Concept

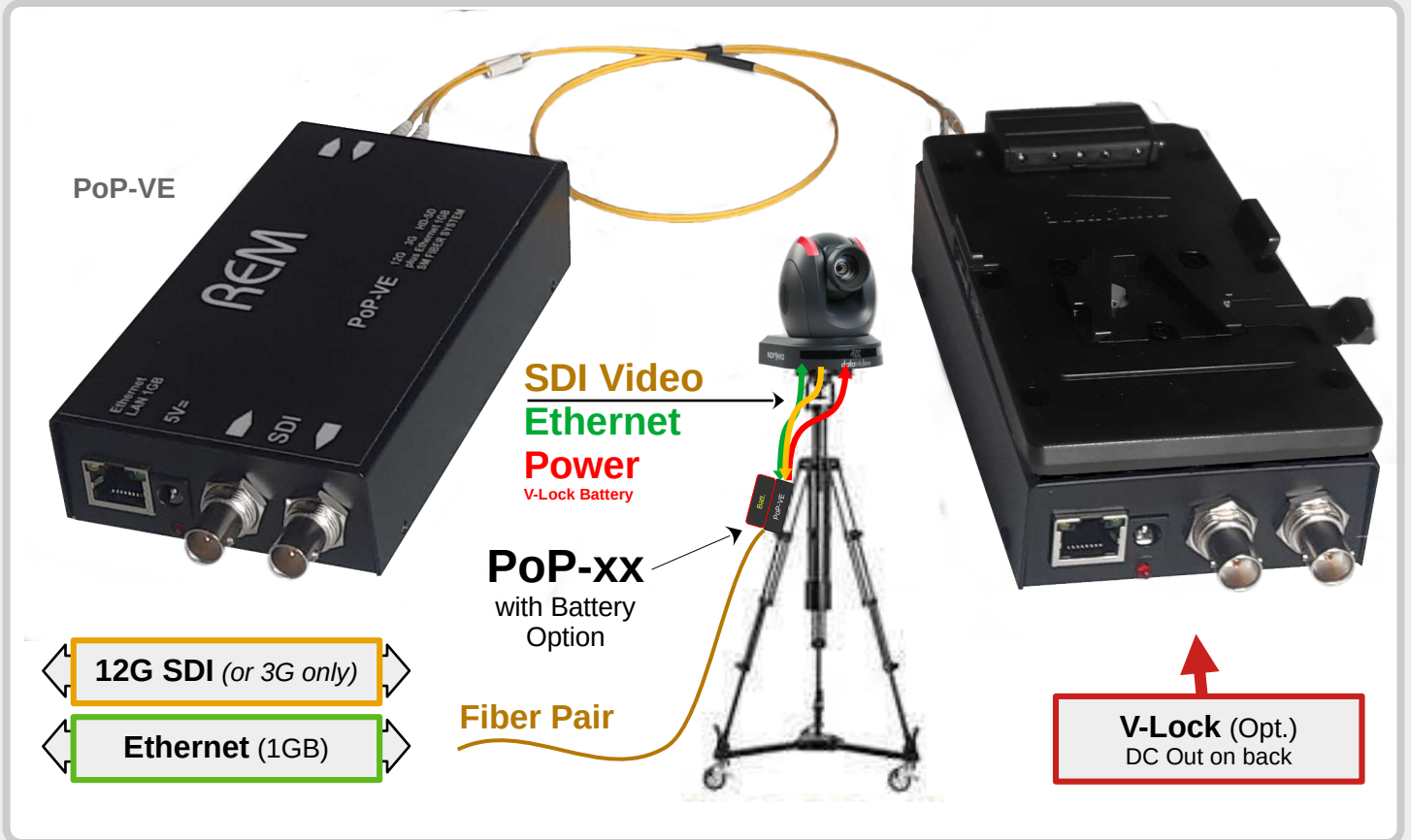

The Battery Option A consist in a V-Lock Adapter to connect the remote PoP-xx to a camera provided of a Vlock Plate
Energy for PoP may be supplied from VLock (reverse) or with it's AC adapter
This configuration allow to connect a camera with a simple LC-LC fiber pair in rugged cable also (PoP-RC)

The Battery Option B consist in a V-Lock Plate to host a battery to energize the remote PoP-xx and the connected Video device like a PTZ with a stable 12Vdc output and/or a USB-C Output (opt.).
This configuration allow to connect the PTZ or with a simple LC-LC fiber pair in rugged cable also (PoP-RC)

Both Options may be mounted in any PoP-xx

Compatible with:

- PoP-VE** PoP with Ethernet 1GB (LAN) transport
- PoP-VF** PoP with FlexyBUS and all connectors on Front side
- PoP-CR** PoP-VE with SFP slot for HDMI Out and Vac input
- PoP-RC** PoP-VE with RUGGED Fiber connectors

PoP-CR